



403.381.7504

The CAPRI

Features:

- Beautifully Designed Custom Home
- Upgraded Kitchen with S/S Appliances
- Quartz Countertops
- Open Concept Design
- Iron Spindle Railing
- Large Great Room w/ Focal Fireplace
- Widegrain Vinyl Plank Floors & Upgraded Carpet
- Master Bedroom W/ Ensuite & Walk In Closet
- Tiled Shower & Built Ins
- Beautiful Main Floor Deck w/ Gas Line
- Hunterdouglas Blinds
- Spacious Basement with additional bedrooms, bath & family room
- Front yard landscaping
- Progressive Home Warranty



MAIN FLOOR 1825 SF

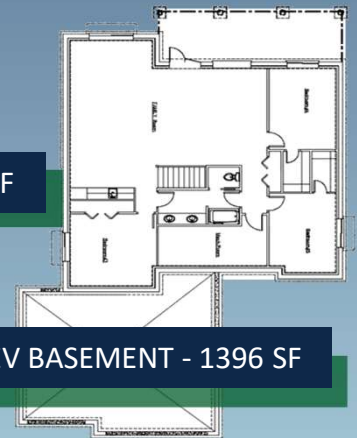

DEV BASEMENT - 1396 SF



716 1ST Ave S – Lethbridge, AB

Please Call To Arrange A Private Viewing!
403.381.7504

